

# 2 SHELF MANAGEMENT



Keeping products organized and shelf displays neat are both key components to increasing sales. Customers can easily find the products they need because shelves stay stocked. With products like Bruegmann Group's line of pushers, products are always fronted, which helps save in labor costs when it comes time to stock shelves. And who doesn't love saving money?

ACCESSORIES .....	47
BACK RAILS .....	45-47
BREAKAWAY DIVIDERS .....	38-41
DIVIDERS .....	30-31
DIVIDER WITH T-RETAINER .....	32-33
DIVIDER WITH RIGHT-RETAINER .....	34-35
DIVIDER WITH LEFT-RETAINER .....	36-37
FLEX ROLLERS .....	48-49
FRONT RAILS .....	44-45
PUSHERS .....	42-43
PUSHER DIVIDER INFOSTRIP .....	45



**60.2 | Divider - Small**

- Divider with front and back attachment points
- Height: 2-3/8" (60mm)
- Material: SAN, PC, Recycled PET



**120.2 | Divider - Tall**

- Divider with front and back attachment points
- Height: 4-3/4" (120mm)
- Material: SAN, PC, Recycled PET

ITEM NO.	PRODUCT NAME	SHELF DEPTH
2.185	DIVIDER - WITH 2 ATTACHMENT POINTS	8"   203mm
2.210	DIVIDER - WITH 2 ATTACHMENT POINTS	9"   228mm
2.235	DIVIDER - WITH 2 ATTACHMENT POINTS	10"   254mm
2.260	DIVIDER - WITH 2 ATTACHMENT POINTS	11"   279mm
2.285	DIVIDER - WITH 2 ATTACHMENT POINTS	12"   304mm
2.310	DIVIDER - WITH 2 ATTACHMENT POINTS	13"   330mm
2.335	DIVIDER - WITH 2 ATTACHMENT POINTS	14"   355mm
2.360	DIVIDER - WITH 2 ATTACHMENT POINTS	15"   381mm
2.385	DIVIDER - WITH 2 ATTACHMENT POINTS	16"   406mm
2.410	DIVIDER - WITH 2 ATTACHMENT POINTS	17"   431mm
2.435	DIVIDER - WITH 2 ATTACHMENT POINTS	18"   457mm
2.460	DIVIDER - WITH 2 ATTACHMENT POINTS	19"   482mm
2.485	DIVIDER - WITH 2 ATTACHMENT POINTS	20"   508mm
2.510	DIVIDER - WITH 2 ATTACHMENT POINTS	21"   533mm

See page 44-47 for mounting rails

60.2/120.2 | --- | ---



**60.1 | Divider - Small**

- Divider with front only attachment point
- Height: 2-3/8" (60mm)
- Material: SAN, PC, Recycled PET



**120.1 | Divider - Tall**

- Divider with front only attachment point
- Height: 4-3/4" (120mm)
- Material: SAN, PC, Recycled PET

ITEM NO.	PRODUCT NAME	SHELF DEPTH
1.180	DIVIDER - WITH 1 ATTACHMENT POINT	8"   203mm
1.205	DIVIDER - WITH 1 ATTACHMENT POINT	9"   228mm
1.230	DIVIDER - WITH 1 ATTACHMENT POINT	10"   254mm
1.255	DIVIDER - WITH 1 ATTACHMENT POINT	11"   279mm
1.280	DIVIDER - WITH 1 ATTACHMENT POINT	12"   304mm
1.305	DIVIDER - WITH 1 ATTACHMENT POINT	13"   330mm
1.330	DIVIDER - WITH 1 ATTACHMENT POINT	14"   355mm
1.355	DIVIDER - WITH 1 ATTACHMENT POINT	15"   381mm
1.380	DIVIDER - WITH 1 ATTACHMENT POINT	16"   406mm
1.405	DIVIDER - WITH 1 ATTACHMENT POINT	17"   431mm
1.430	DIVIDER - WITH 1 ATTACHMENT POINT	18"   457mm
1.455	DIVIDER - WITH 1 ATTACHMENT POINT	19"   482mm
1.480	DIVIDER - WITH 1 ATTACHMENT POINT	20"   508mm
1.505	DIVIDER - WITH 1 ATTACHMENT POINT	21"   533mm

See page 44-47 for mounting rails

60.1/120.1 | --- | ---



**60.2.T | Divider - Small**

- Divider with front and back attachment points
- Front T-Retainer
- Height: 2-3/8" (60mm)
- Material: SAN, PC, Recycled PET



**120.2.T | Divider - Tall**

- Divider with front and back attachment points
- Front T-Retainer
- Retainer Height: 2-3/8" (60mm)
- Divider Height: 4-3/4" (120mm)
- Material: SAN, PC, Recycled PET

ITEM NO.	PRODUCT NAME	SHELF DEPTH
2.T.185	DIVIDER - WITH T-RETAINER AND 2 ATTACHMENT POINTS	8"   203mm
2.T.210	DIVIDER - WITH T-RETAINER AND 2 ATTACHMENT POINTS	9"   228mm
2.T.235	DIVIDER - WITH T-RETAINER AND 2 ATTACHMENT POINTS	10"   254mm
2.T.260	DIVIDER - WITH T-RETAINER AND 2 ATTACHMENT POINTS	11"   279mm
2.T.285	DIVIDER - WITH T-RETAINER AND 2 ATTACHMENT POINTS	12"   304mm
2.T.310	DIVIDER - WITH T-RETAINER AND 2 ATTACHMENT POINTS	13"   330mm
2.T.335	DIVIDER - WITH T-RETAINER AND 2 ATTACHMENT POINTS	14"   355mm
2.T.360	DIVIDER - WITH T-RETAINER AND 2 ATTACHMENT POINTS	15"   381mm
2.T.385	DIVIDER - WITH T-RETAINER AND 2 ATTACHMENT POINTS	16"   406mm
2.T.410	DIVIDER - WITH T-RETAINER AND 2 ATTACHMENT POINTS	17"   431mm
2.T.435	DIVIDER - WITH T-RETAINER AND 2 ATTACHMENT POINTS	18"   457mm
2.T.460	DIVIDER - WITH T-RETAINER AND 2 ATTACHMENT POINTS	19"   482mm
2.T.485	DIVIDER - WITH T-RETAINER AND 2 ATTACHMENT POINTS	20"   508mm
2.T.510	DIVIDER - WITH T-RETAINER AND 2 ATTACHMENT POINTS	21"   533mm

See page 44-47 for mounting rails

60.2.T/120.2.T | --- | ---

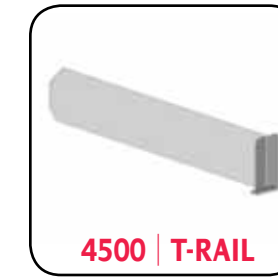

**60.1.T | Divider - Small**

- Divider with front only attachment point
- Front T-Retainer
- Height: 2-3/8" (60mm)
- Material: SAN, PC, Recycled PET

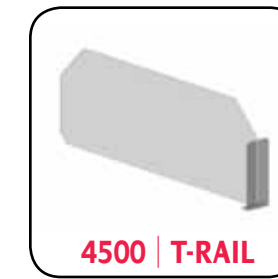

**120.1.T | Divider - Tall**

- Divider with front only attachment point
- Front T-Retainer
- Retainer Height: 2-3/8" (60mm)
- Divider Height: 4-3/4" (120mm)
- Material: SAN, PC, Recycled PET

ITEM NO.	PRODUCT NAME	SHELF DEPTH
1.T.180	DIVIDER - WITH T-RETAINER AND 1 ATTACHMENT POINT	8"   203mm
1.T.205	DIVIDER - WITH T-RETAINER AND 1 ATTACHMENT POINT	9"   228mm
1.T.230	DIVIDER - WITH T-RETAINER AND 1 ATTACHMENT POINT	10"   254mm
1.T.255	DIVIDER - WITH T-RETAINER AND 1 ATTACHMENT POINT	11"   279mm
1.T.280	DIVIDER - WITH T-RETAINER AND 1 ATTACHMENT POINT	12"   304mm
1.T.305	DIVIDER - WITH T-RETAINER AND 1 ATTACHMENT POINT	13"   330mm
1.T.330	DIVIDER - WITH T-RETAINER AND 1 ATTACHMENT POINT	14"   355mm
1.T.355	DIVIDER - WITH T-RETAINER AND 1 ATTACHMENT POINT	15"   381mm
1.T.380	DIVIDER - WITH T-RETAINER AND 1 ATTACHMENT POINT	16"   406mm
1.T.405	DIVIDER - WITH T-RETAINER AND 1 ATTACHMENT POINT	17"   431mm
1.T.430	DIVIDER - WITH T-RETAINER AND 1 ATTACHMENT POINT	18"   457mm
1.T.455	DIVIDER - WITH T-RETAINER AND 1 ATTACHMENT POINT	19"   482mm
1.T.480	DIVIDER - WITH T-RETAINER AND 1 ATTACHMENT POINT	20"   508mm
1.T.505	DIVIDER - WITH T-RETAINER AND 1 ATTACHMENT POINT	21"   533mm

See page 44-47 for mounting rails

60.1.T/120.1.T | --- | ---



**60.2.LR | Divider - Small**

- Divider with front and back attachment points
- Front Right-Retainer
- Height: 2-3/8" (60mm)
- Material: SAN, PC, Recycled PET



**120.2.LR | Divider - Tall**

- Divider with front and back attachment points
- Front Right-Retainer
- Retainer Height: 2-3/8" (60mm)
- Divider Height: 4-3/4" (120mm)
- Material: SAN, PC, Recycled PET

ITEM NO.	PRODUCT NAME	SHELF DEPTH
2.LR.185	DIVIDER - WITH RIGHT-RETAINER AND 2 ATTACHMENT POINTS	8"   203mm
2.LR.210	DIVIDER - WITH RIGHT-RETAINER AND 2 ATTACHMENT POINTS	9"   228mm
2.LR.235	DIVIDER - WITH RIGHT-RETAINER AND 2 ATTACHMENT POINTS	10"   254mm
2.LR.260	DIVIDER - WITH RIGHT-RETAINER AND 2 ATTACHMENT POINTS	11"   279mm
2.LR.285	DIVIDER - WITH RIGHT-RETAINER AND 2 ATTACHMENT POINTS	12"   304mm
2.LR.310	DIVIDER - WITH RIGHT-RETAINER AND 2 ATTACHMENT POINTS	13"   330mm
2.LR.335	DIVIDER - WITH RIGHT-RETAINER AND 2 ATTACHMENT POINTS	14"   355mm
2.LR.360	DIVIDER - WITH RIGHT-RETAINER AND 2 ATTACHMENT POINTS	15"   381mm
2.LR.385	DIVIDER - WITH RIGHT-RETAINER AND 2 ATTACHMENT POINTS	16"   406mm
2.LR.410	DIVIDER - WITH RIGHT-RETAINER AND 2 ATTACHMENT POINTS	17"   431mm
2.LR.435	DIVIDER - WITH RIGHT-RETAINER AND 2 ATTACHMENT POINTS	18"   457mm
2.LR.460	DIVIDER - WITH RIGHT-RETAINER AND 2 ATTACHMENT POINTS	19"   482mm
2.LR.485	DIVIDER - WITH RIGHT-RETAINER AND 2 ATTACHMENT POINTS	20"   508mm
2.LR.510	DIVIDER - WITH RIGHT-RETAINER AND 2 ATTACHMENT POINTS	21"   533mm

See page 44-47 for mounting rails

60.2.LR/120.2.LR | --- | ---

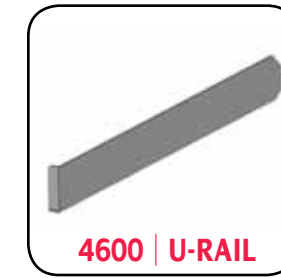
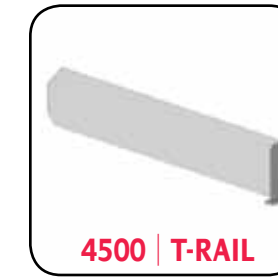

**60.1.LR | Divider - Small**

- Divider with front only attachment point
- Front Right-Retainer
- Height: 2-3/8" (60mm)
- Material: SAN, PC, Recycled PET

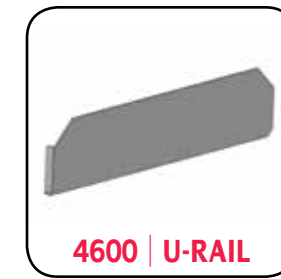

**120.1.LR | Divider - Tall**

- Divider with front and back attachment points
- Front Right-Retainer
- Retainer Height: 2-3/8" (60mm)
- Divider Height: 4-3/4" (120mm)
- Material: SAN, PC, Recycled PET

ITEM NO.	PRODUCT NAME	SHELF DEPTH
1.LR.180	DIVIDER - WITH RIGHT-RETAINER AND 1 ATTACHMENT POINT	8"   203mm
1.LR.205	DIVIDER - WITH RIGHT-RETAINER AND 1 ATTACHMENT POINT	9"   228mm
1.LR.230	DIVIDER - WITH RIGHT-RETAINER AND 1 ATTACHMENT POINT	10"   254mm
1.LR.255	DIVIDER - WITH RIGHT-RETAINER AND 1 ATTACHMENT POINT	11"   279mm
1.LR.280	DIVIDER - WITH RIGHT-RETAINER AND 1 ATTACHMENT POINT	12"   304mm
1.LR.305	DIVIDER - WITH RIGHT-RETAINER AND 1 ATTACHMENT POINT	13"   330mm
1.LR.330	DIVIDER - WITH RIGHT-RETAINER AND 1 ATTACHMENT POINT	14"   355mm
1.LR.355	DIVIDER - WITH RIGHT-RETAINER AND 1 ATTACHMENT POINT	15"   381mm
1.LR.380	DIVIDER - WITH RIGHT-RETAINER AND 1 ATTACHMENT POINT	16"   406mm
1.LR.405	DIVIDER - WITH RIGHT-RETAINER AND 1 ATTACHMENT POINT	17"   431mm
1.LR.430	DIVIDER - WITH RIGHT-RETAINER AND 1 ATTACHMENT POINT	18"   457mm
1.LR.455	DIVIDER - WITH RIGHT-RETAINER AND 1 ATTACHMENT POINT	19"   482mm
1.LR.480	DIVIDER - WITH RIGHT-RETAINER AND 1 ATTACHMENT POINT	20"   508mm
1.LR.505	DIVIDER - WITH RIGHT-RETAINER AND 1 ATTACHMENT POINT	21"   533mm

See page 44-47 for mounting rails

60.1.LR/120.1.LR | --- | ---



**60.2.LL | Divider - Small**

- Divider with front and back attachment points
- Front Left Retainer
- Height: 2-3/8" (60mm)
- Material: SAN, PC, Recycled PET

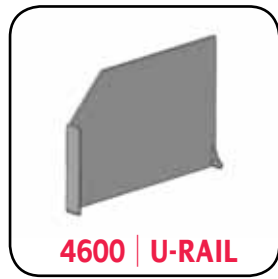

**120.2.LL | Divider - Tall**

- Divider with front and back attachment points
- Front Left-Retainer
- Retainer Height: 2-3/8" (60mm)
- Divider Height: 4-3/4" (120mm)
- Material: SAN, PC, Recycled PET

ITEM NO.	PRODUCT NAME	SHELF DEPTH	
2.LL.185	DIVIDER - WITH LEFT-RETAINER AND 2 ATTACHMENT POINTS	8"	203mm
2.LL.210	DIVIDER - WITH LEFT-RETAINER AND 2 ATTACHMENT POINTS	9"	228mm
2.LL.235	DIVIDER - WITH LEFT-RETAINER AND 2 ATTACHMENT POINTS	10"	254mm
2.LL.260	DIVIDER - WITH LEFT-RETAINER AND 2 ATTACHMENT POINTS	11"	279mm
2.LL.285	DIVIDER - WITH LEFT-RETAINER AND 2 ATTACHMENT POINTS	12"	304mm
2.LL.310	DIVIDER - WITH LEFT-RETAINER AND 2 ATTACHMENT POINTS	13"	330mm
2.LL.335	DIVIDER - WITH LEFT-RETAINER AND 2 ATTACHMENT POINTS	14"	355mm
2.LL.360	DIVIDER - WITH LEFT-RETAINER AND 2 ATTACHMENT POINTS	15"	381mm
2.LL.385	DIVIDER - WITH LEFT-RETAINER AND 2 ATTACHMENT POINTS	16"	406mm
2.LL.410	DIVIDER - WITH LEFT-RETAINER AND 2 ATTACHMENT POINTS	17"	431mm
2.LL.435	DIVIDER - WITH LEFT-RETAINER AND 2 ATTACHMENT POINTS	18"	457mm
2.LL.460	DIVIDER - WITH LEFT-RETAINER AND 2 ATTACHMENT POINTS	19"	482mm
2.LL.485	DIVIDER - WITH LEFT-RETAINER AND 2 ATTACHMENT POINTS	20"	508mm
2.LL.510	DIVIDER - WITH LEFT-RETAINER AND 2 ATTACHMENT POINTS	21"	533mm

See page 44-47 for mounting rails

60.2.LL/120.2.LL | --- | ---

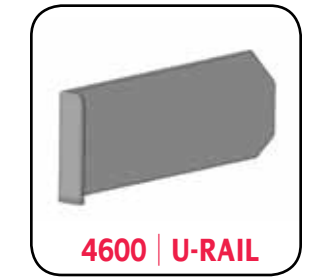
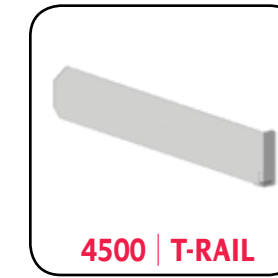

**60.1.LL | Divider - Small**

- Divider with front only attachment point
- Front Left-Retainer
- Height: 2-3/8" (60mm)
- Material: SAN, PC, Recycled PET

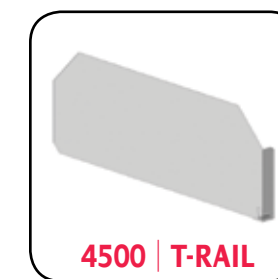

**120.1.LL | Divider - Tall**

- Divider with front only attachment point
- Front Left-Retainer
- Retainer Height: 2-3/8" (60mm)
- Divider Height: 4-3/4" (120mm)
- Material: SAN, PC, Recycled PET

ITEM NO.	PRODUCT NAME	SHELF DEPTH	
1.LL.185	DIVIDER - WITH LEFT-RETAINER AND 1 ATTACHMENT POINT	8"	203mm
1.LL.210	DIVIDER - WITH LEFT-RETAINER AND 1 ATTACHMENT POINT	9"	228mm
1.LL.235	DIVIDER - WITH LEFT-RETAINER AND 1 ATTACHMENT POINT	10"	254mm
1.LL.260	DIVIDER - WITH LEFT-RETAINER AND 1 ATTACHMENT POINT	11"	279mm
1.LL.285	DIVIDER - WITH LEFT-RETAINER AND 1 ATTACHMENT POINT	12"	304mm
1.LL.310	DIVIDER - WITH LEFT-RETAINER AND 1 ATTACHMENT POINT	13"	330mm
1.LL.335	DIVIDER - WITH LEFT-RETAINER AND 1 ATTACHMENT POINT	14"	355mm
1.LL.360	DIVIDER - WITH LEFT-RETAINER AND 1 ATTACHMENT POINT	15"	381mm
1.LL.385	DIVIDER - WITH LEFT-RETAINER AND 1 ATTACHMENT POINT	16"	406mm
1.LL.410	DIVIDER - WITH LEFT-RETAINER AND 1 ATTACHMENT POINT	17"	431mm
1.LL.435	DIVIDER - WITH LEFT-RETAINER AND 1 ATTACHMENT POINT	18"	457mm
1.LL.460	DIVIDER - WITH LEFT-RETAINER AND 1 ATTACHMENT POINT	19"	482mm
1.LL.485	DIVIDER - WITH LEFT-RETAINER AND 1 ATTACHMENT POINT	20"	508mm
1.LL.510	DIVIDER - WITH LEFT-RETAINER AND 1 ATTACHMENT POINT	21"	533mm

See page 44-47 for mounting rails

60.1.LL/120.60.1.LL | --- | ---



**35.2B | Breakaway Divider**

- Front and back mounting points
- Height: 1-3/8" (35mm)
- Mounting Options: T-Rail (4500)
- Material: SAN, PC, HIPS, Recycled PET

ITEM NO.	PRODUCT NAME	DIVIDER DEPTH
35.2B.335	BREAKAWAY DIVIDER	13-1/8", breakaway in 1" increments to 7-1/4"   335mm, breakaway in 25mm increments to 185mm
35.2B.485	BREAKAWAY DIVIDER	19", breakaway in 1" increments to 13-1/8"   485mm, breakaway in 25mm increments to 335mm

35.2B | --- | ---



**35.2B.LL | Breakaway Divider**

- Front and back mounting points
- Height: 1-3/8" (35mm)
- Front left retainer
- Mounting Options: T-Rail (4500)
- Material: SAN, PC, HIPS, Recycled PET

ITEM NO.	PRODUCT NAME	DIVIDER DEPTH
35.2B.LL.335	BREAKAWAY DIVIDER	13-1/8", breakaway in 1" increments to 7-1/4"   335mm, breakaway in 25mm increments to 185mm
35.2B.LL.485	BREAKAWAY DIVIDER	19", breakaway in 1" increments to 13-1/8"   485mm, breakaway in 25mm increments to 335mm

35.2B.LL | --- | ---

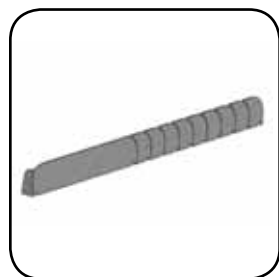

**35.2B.LR | Breakaway Divider**

- Front and back mounting points
- Height: 1-3/8" (35mm)
- Front right retainer
- Mounting Options: T-Rail (4500)
- Material: SAN, PC, HIPS, Recycled PET

ITEM NO.	PRODUCT NAME	DIVIDER DEPTH
35.2B.LR.335	BREAKAWAY DIVIDER	13-1/8", breakaway in 1" increments to 7-1/4"   335mm, breakaway in 25mm increments to 185mm
35.2B.LR.485	BREAKAWAY DIVIDER	19", breakaway in 1" increments to 13-1/8"   485mm, breakaway in 25mm increments to 335mm

35.2B.LR | --- | ---

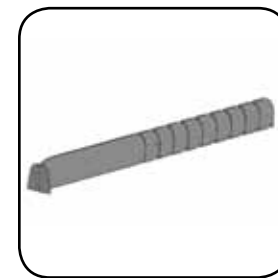

**35.2B.T | Breakaway Divider**

- Front and back mounting points
- Height: 1-3/8" (35mm)
- Front T-retainer
- Mounting Options: T-Rail (4500)
- Material: SAN, PC, HIPS, Recycled PET

ITEM NO.	PRODUCT NAME	DIVIDER DEPTH
35.2B.T.335	BREAKAWAY DIVIDER	13-1/8", breakaway in 1" increments to 7-1/4"   335mm, breakaway in 25mm increments to 185mm
35.2B.T.485	BREAKAWAY DIVIDER	19", breakaway in 1" increments to 13-1/8"   485mm, breakaway in 25mm increments to 335mm

35.2B.T | --- | ---

**60.2B | Breakaway Divider**

- Front and back mounting points
- Height: 2-3/8" (60mm)
- Mounting Options: T-Rail (4500)
- Material: SAN, PC, HIPS, Recycled PET

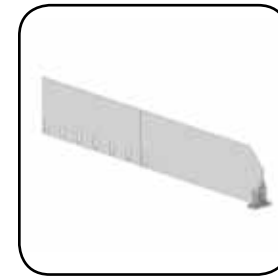

ITEM NO.	PRODUCT NAME	DIVIDER DEPTH
60.2B.335	BREAKAWAY DIVIDER	13-1/8", breakaway in 1" increments to 7-1/4"   335mm, breakaway in 25mm increments to 185mm
60.2B.485	BREAKAWAY DIVIDER	19", breakaway in 1" increments to 13-1/8"   485mm, breakaway in 25mm increments to 335mm

60.2B.T | --- | ---

**60.2B.LL | Breakaway Divider**

- Front and back mounting points
- Height: 2-3/8" (60mm)
- Front Left-Retainer
- Mounting Options: T-Rail (4500)
- Material: SAN, PC, HIPS, Recycled PET

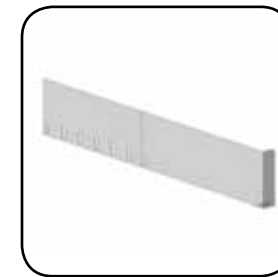

ITEM NO.	PRODUCT NAME	DIVIDER DEPTH	DIMENSIONS
60.2B.LL.335	BREAKAWAY DIVIDER	13-1/8", breakaway in 1" increments to 7-1/4"   335mm, breakaway in 25mm increments to 185mm	
60.2B.LL.485	BREAKAWAY DIVIDER	19", breakaway in 1" increments to 13-1/8"   485mm, breakaway in 25mm increments to 335mm	

60.2B.LL | --- | ---

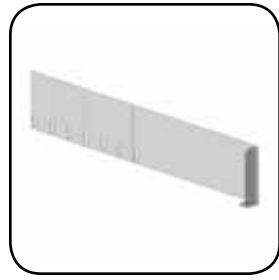

**60.2B.LR | Breakaway Divider**

- Front and back mounting points
- Height: 2-3/8" (60mm)
- Front Right-Retainer
- Mounting Options: T-Rail (4500)
- Material: SAN, PC, HIPS, Recycled PET

ITEM NO.	PRODUCT NAME	DIVIDER DEPTH	DIMENSIONS
60.2B.LR.335	BREAKAWAY DIVIDER	13-1/8", breakaway in 1" increments to 7-1/4"	335mm, breakaway in 25mm increments to 185mm
60.2B.LR.485	BREAKAWAY DIVIDER	19", breakaway in 1" increments to 13-1/8"	485mm, breakaway in 25mm increments to 335mm

60.2B.LR | --- | ---

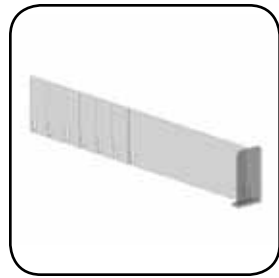

**60.2B.T | Breakaway Divider**

- Front and back mounting points
- Height: 2-3/8" (60mm)
- Front T-Retainer
- Mounting Options: T-Rail (4500)
- Material: SAN, PC, HIPS, Recycled PET

ITEM NO.	PRODUCT NAME	DIVIDER DEPTH	DIMENSIONS
60.2B.T.335	BREAKAWAY DIVIDER	13-1/8", breakaway in 1" increments to 7-1/4"	335mm, breakaway in 25mm increments to 185mm
60.2B.T.485	BREAKAWAY DIVIDER	19", breakaway in 1" increments to 13-1/8"	485mm, breakaway in 25mm increments to 335mm

60.2B.T | --- | ---



**120.2B | Breakaway Divider**

- Front and back mounting points
- Divider Height: 4-3/4" (120mm)
- Mounting Options: T-Rail (4500)
- Material: SAN, PC, HIPS, Recycled PET

ITEM NO.	PRODUCT NAME	DIMENSIONS
120.2B.335	BREAKAWAY DIVIDER	13-1/8", breakaway in 1" increments to 7-1/4"   335mm, breakaway in 25mm increments to 185mm
120.2B.485	BREAKAWAY DIVIDER	19", breakaway in 1" increments to 13-1/8"   485mm, breakaway in 25mm increments to 335mm

120.2B | --- | ---

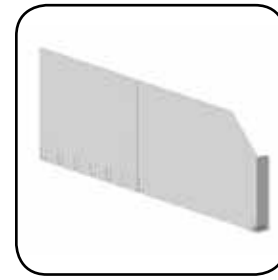

**120.2B.LL | Breakaway Divider**

- Front and back mounting points
- Front Left-Retainer
- Divider Height: 4-3/4" (120mm)
- Mounting Options: T-Rail (4500)
- Material: SAN, PC, HIPS, Recycled PET

ITEM NO.	PRODUCT NAME	DIMENSIONS
120.2B.LL.335	BREAKAWAY DIVIDER	13-1/8", breakaway in 1" increments to 7-1/4"   335mm, breakaway in 25mm increments to 185mm
120.2B.LL.485	BREAKAWAY DIVIDER	19", breakaway in 1" increments to 13-1/8"   485mm, breakaway in 25mm increments to 335mm

120.2B.LL | --- | ---

**120.2B.LR | Breakaway Divider**

- Front and back mounting points
- Front Right-Retainer
- Divider Height: 4-3/4" (120mm)
- Mounting Options: T-Rail (4500)
- Material: SAN, PC, HIPS, Recycled PET

ITEM NO.	PRODUCT NAME	DIMENSIONS
120.2B.LR.335	BREAKAWAY DIVIDER	13-1/8", breakaway in 1" increments to 7-1/4"   335mm, breakaway in 25mm increments to 185mm
120.2B.LR.485	BREAKAWAY DIVIDER	19", breakaway in 1" increments to 13-1/8"   485mm, breakaway in 25mm increments to 335mm

120.2B.LR | --- | ---

**120.2B.T | Breakaway Divider**

- Front and back mounting points
- Front T-Retainer
- Divider Height: 4-3/4" (120mm)
- Mounting Options: T-Rail (4500)
- Material: SAN, PC, HIPS, Recycled PET

ITEM NO.	PRODUCT NAME	DIMENSIONS
120.2B.T.335	BREAKAWAY DIVIDER	13-1/8", breakaway in 1" increments to 7-1/4"   335mm, breakaway in 25mm increments to 185mm
120.2B.T.485	BREAKAWAY DIVIDER	19", breakaway in 1" increments to 13-1/8"   485mm, breakaway in 25mm increments to 335mm

120.2B.T | --- | ---

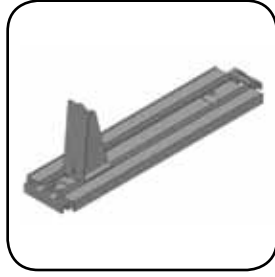

PU.50 | --- | ---

**PU.50 | Wide Pusher**

- Pusher with front and back attachment points
- Track width: 2" (50mm)
- Available for any depth
- Mounting Options: T-Rail (4500), U-Rail (4600)

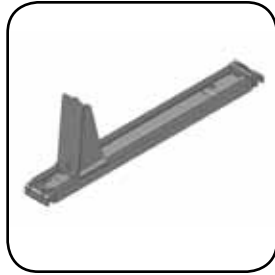

PU.25 | --- | ---

**PU.25 | Narrow Pusher**

- Pusher with front and back attachment points
- Track width: 1" (25mm)
- Available for any depth
- Mounting Options: T-Rail (4500), U-Rail (4600)



PU.F | --- | ---

**PU.F | Pusher**

- Pusher with front only attachment point
- Available for any depth



PU.50B | --- | ---

**PU.50B | Wide Pusher Breakaway**

- Pusher with front and back attachment points
- Breakaway in 1" (25mm) increments
- Track width: 2" (50mm)
- Available for any depth
- Mounting Options: T-Rail (4500), U-Rail (4600)

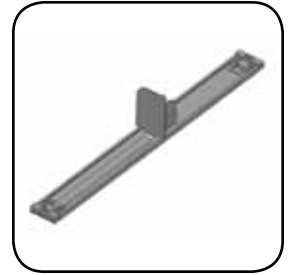

PU.30 | --- | ---

**PU.30 | Rokit Pusher**

- Pusher with front and back attachment points
- Low profile
- Track width: 1-1/8" (30mm)
- Available for any depth
- Mounting Option: U-Rail (4600)

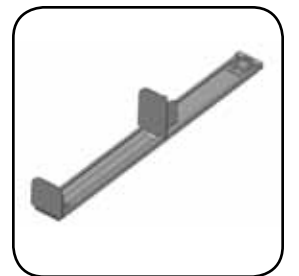

PU.30F | --- | ---

**PU.30F | Rokit Pusher**

- Pusher with front and back attachment points
- Includes front retainer
- Low profile
- Track width: 1-1/8" (30mm)
- Available for any depth
- Mounting Option: U-Rail (4600)



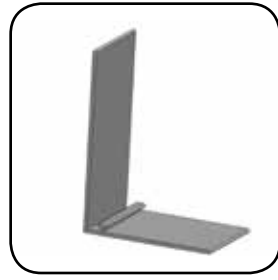

P49.T.ADH | --- | ---

**P49.T.ADH | Front T-Rail**

- Front rail with adhesive
- Retainer height: 2" (50mm)
- Available in custom lengths

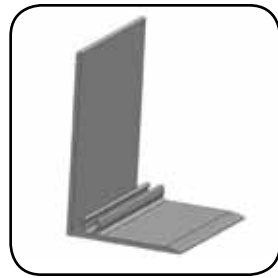

P49.U.ADH | --- | ---

**P49.U.ADH | Front U-Rail**

- Front rail with adhesive
- Retainer height: 2" (50mm)
- Available in custom lengths

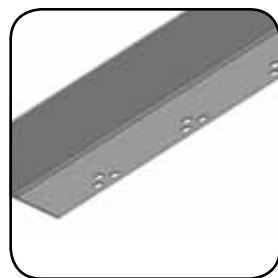

P49.T.HOL | --- | ---

**P49.T.HOL | Front T-Rail W/ Holes**

- Front rail with holes for pegs (PEG - pg 47)
- Hole location determined by customer
- Retainer height: 2" (50mm)
- Available in custom lengths



P49.U.HOL | --- | ---

**P49.U.HOL | Front U-Rail W/ Holes**

- Front rail with holes for pegs (PEG - pg 47)
- Hole location determined by customer
- Retainer height: 2" (50mm)
- Available in custom lengths

**PDI | Pusher and Divider Rail Infostrip**

- Mounts to flat shelf edge with permanent adhesive
- Includes T-Rail for 4500 series pusher/divider installation
- Price labels are displayed behind clear window
- Also available in custom colors and lengths



ITEM NO.	PRODUCT NAME	LABEL HEIGHT
PDI	PUSHER AND DIVIDER RAIL INFOSTRIP	1-1/2"   40mm

PDI 33/90 | --- | ---

**P30.T.ADH | Back T-Rail**

- Back rail with adhesive
- Base width: 1-1/8" (30mm)
- Available in custom lengths

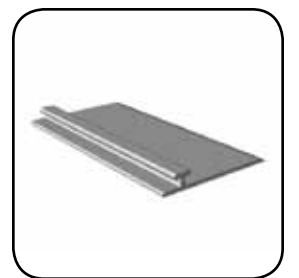

P30.T.ADH | --- | ---

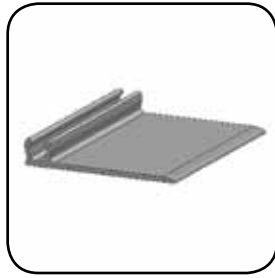

P30.U.ADH | --- | ---

**P30.U.ADH | Back U-Rail**

- Back rail with adhesive
- Base width: 1-1/8" (30mm)
- Available in custom lengths



P30.T.HOL | --- | ---

**P30.T.HOL | Back T-Rail w/ Holes**

- Back rail with holes for pegs (PEG - pg 47)
- Hole location determined by customer
- Base width: 1-1/8" (30mm)
- Available in custom lengths

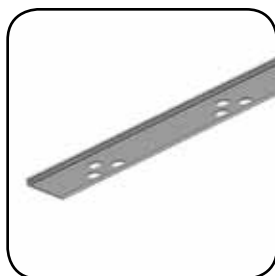

P30.U.HOL | --- | ---

**P30.U.HOL | Back U-Rail w/ Holes**

- Back rail with holes for pegs (PEG - pg 47)
- Hole location determined by customer
- Base width: 1-1/8" (30mm)
- Available in custom lengths



P13.T.ADH | --- | ---

**P13.T.ADH | Back T-Rail**

- Back rail with adhesive
- Base width: 1/2" (13mm)
- Available in custom lengths

**PEG | Pusher Rail Peg**

- Mounts rail to metal shelving



PEG | --- | ---

**RU | Pusher Paddle**

- Clips onto Pusher housing



RU | --- | ---

ITEM NO.	PRODUCT NAME	WIDTH
RU60	PUSHER PADDLE	2-3/8"   60mm
RU90	PUSHER PADDLE	3-1/2"   90mm



CV.FR | --- | ---

**CV.FR | Cold Vault FlexRoller**

- Fits onto existing wire racks
- More efficient substitute to plastic glides
- Also available in custom widths and depths



GON.FR | --- | ---

**GON.FR | Gondola FlexRoller**

- Mounts into existing gondola shelving
- Delivers products to shelf edge at a 3-6 degree angle

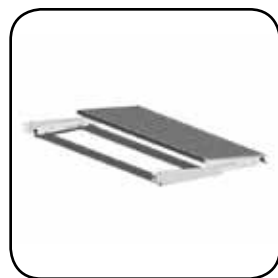

PO.FR | --- | ---

**PO.FR | Pull-Out FlexRoller**

- Mounts into gondola shelving
- Glide tracks allow shelf to pull out for back loading
- Delivers products to shelf edge at a 3-6 degree angle



YOG.FR | --- | ---

**YOG.FR | Yogurt FlexRoller**

- Individual lanes for different flavors
- Mounts into gondola shelving
- Glide tracks allow sections of the shelf or the complete shelf to pull out for back loading
- Yogurt specific dividers keep product organized

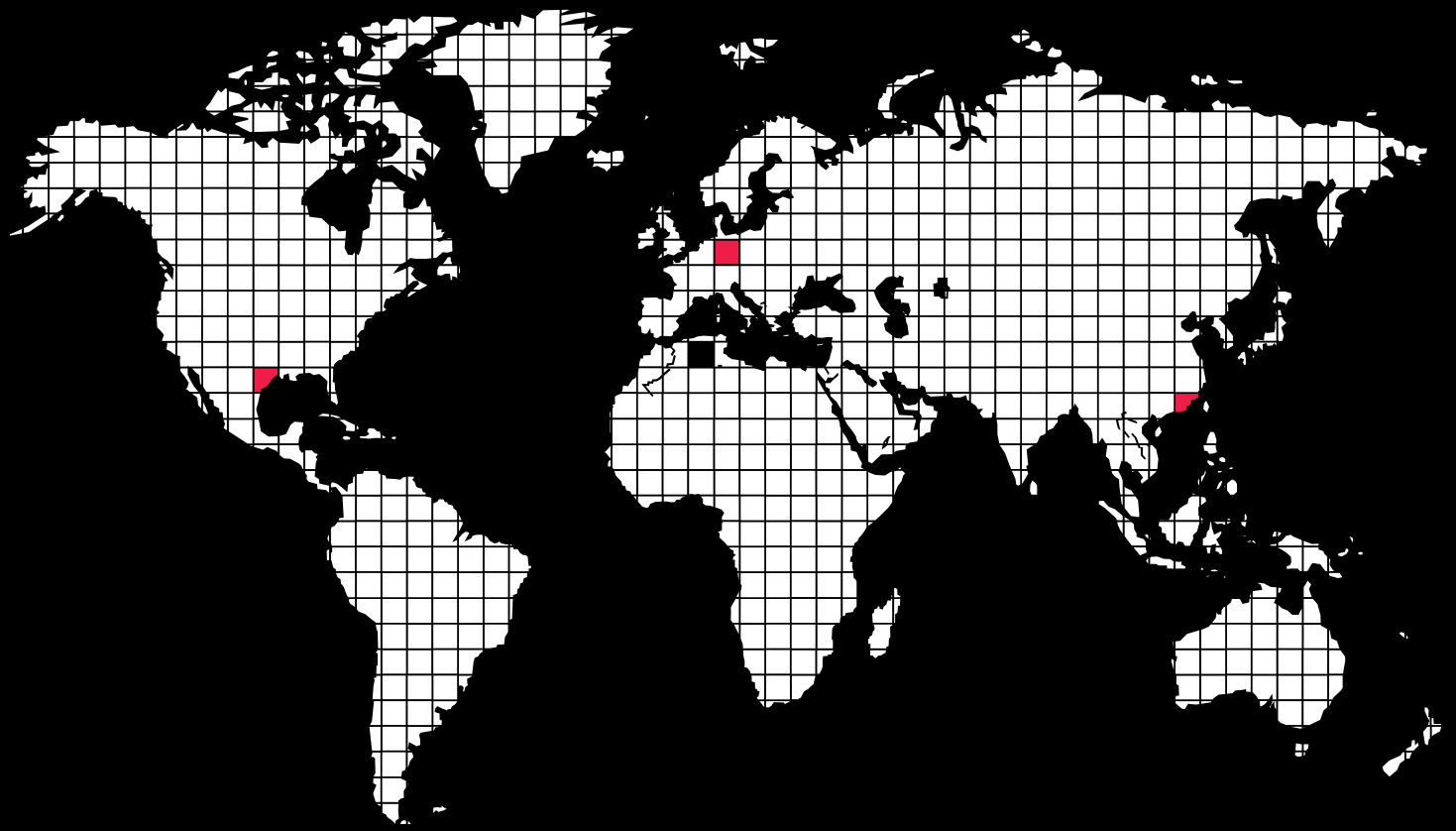

Bruegmann USA, Inc.  
8820 Frey Road  
Houston, TX 77034  
USA

P: +1 888 745 9229  
F: +1 832 550 2095  
Contact: Don Jett  
don@bruegmann-usa.com

[www.bruegmann-usa.com](http://www.bruegmann-usa.com)



Bruegmann Germany GmbH & Co KG  
Werkzeugstrasse 18-24  
58239 Hagen  
Germany

P: +49 2331 9598-0  
F: +49 2331 9598-99  
Contact: Angela Adam  
a.adam@bruegmann-kunststoff.de

[www.bruegmann-kunststoff.de](http://www.bruegmann-kunststoff.de)



Bruegmann China Plastics Technology, Ltd.  
No. 52 Hong Wan Free Trade Zone  
Zhuhai, Guangdong, P.R. China  
Postal Code: 519030

P: +86 756 8686 796  
F: +86 756 8686 795  
Contact: Karen Liu  
karen@bruegmann-china.com

[www.bruegmann-china.com](http://www.bruegmann-china.com)